



MATANUSKA-SUSITNA BOROUGH  
Community Development  
Land Management Division  
350 East Dahlia Avenue  
Palmer, Alaska 99645

---

MATANUSKA-SUSITNA BOROUGH  
**PUBLIC NOTICE**

**Type: Timber Harvest (MSB007991)**

**Tax ID: 19N04W32B001, 19N04W32B002,  
19N04W29C005, 19N04W29C006, 19N04W29C007**

The Matanuska-Susitna Borough (MSB) Land and Resource Management Division is proposing an over-the-counter salvage timber harvest on approximately 137 acres of forested land across five adjacent Borough parcels (19N04W32B001, 19N04W32B002, 19N04W29C005, 19N04W29C006, 19N04W29C007). The five parcels encompass 279.5 acres, but only 137 acres are included in the proposed harvest area and may be subject to change based on detailed analysis of forest inventory data and site evaluations.

Going forward, the forest management activities will focus on several key goals. These include the reduction of birch stocking, as well as the removal of beetle-killed spruce trees. Certain number of trees per acre will be retained to enhance the aesthetic quality of the area and improve potential access for future Borough land sales while reducing the overall threat of wildfire.

Supporting material is available for public inspection during normal business hours on the 2<sup>nd</sup> floor of the Matanuska-Susitna Borough Building in the Land Management Division or visit the Public Notice Section on the Borough's web page [www.matsugov.us](http://www.matsugov.us). Public comment is invited on this request. If you have any comments please mail or deliver them to the Borough offices at the address indicated above, no later than **March 24, 2023**. If you have questions about this request: call Emerson Krueger at 861-7867, or Christian Munar at 861-7863 between 8:00-5:00 or you can send an e-mail to: [LMB@matsugov.us](mailto:LMB@matsugov.us) (please refer to **MSB007991 Long Lake Rd Timber Harvest when submitting comments**).

Comments: \_\_\_\_\_

\_\_\_\_\_

\_\_\_\_\_

\_\_\_\_\_

\_\_\_\_\_

\_\_\_\_\_

\_\_\_\_\_

\_\_\_\_\_

\_\_\_\_\_

\_\_\_\_\_

Signature: \_\_\_\_\_

# Long Lake Rd Potential Timber Harvest Area

MSB007991

Township 19 North, Range 04 West, Sec. 29 & 32

Timber Harvest Boundary

Mat-Su Borough

Wetlands

Waterbodies

ROW Easements

Right of Way

Section Line Easement



A buffer zone of 100 feet has been established to protect the wetlands, property boundaries, and rights of way.

The total operable area for timber harvesting is estimated to be around 127 acres, with 53 acres located to the north of Long Lake Rd. and 74 acres to the south.

The exact size available for timber harvesting and buffer zones may be subject to change over time.

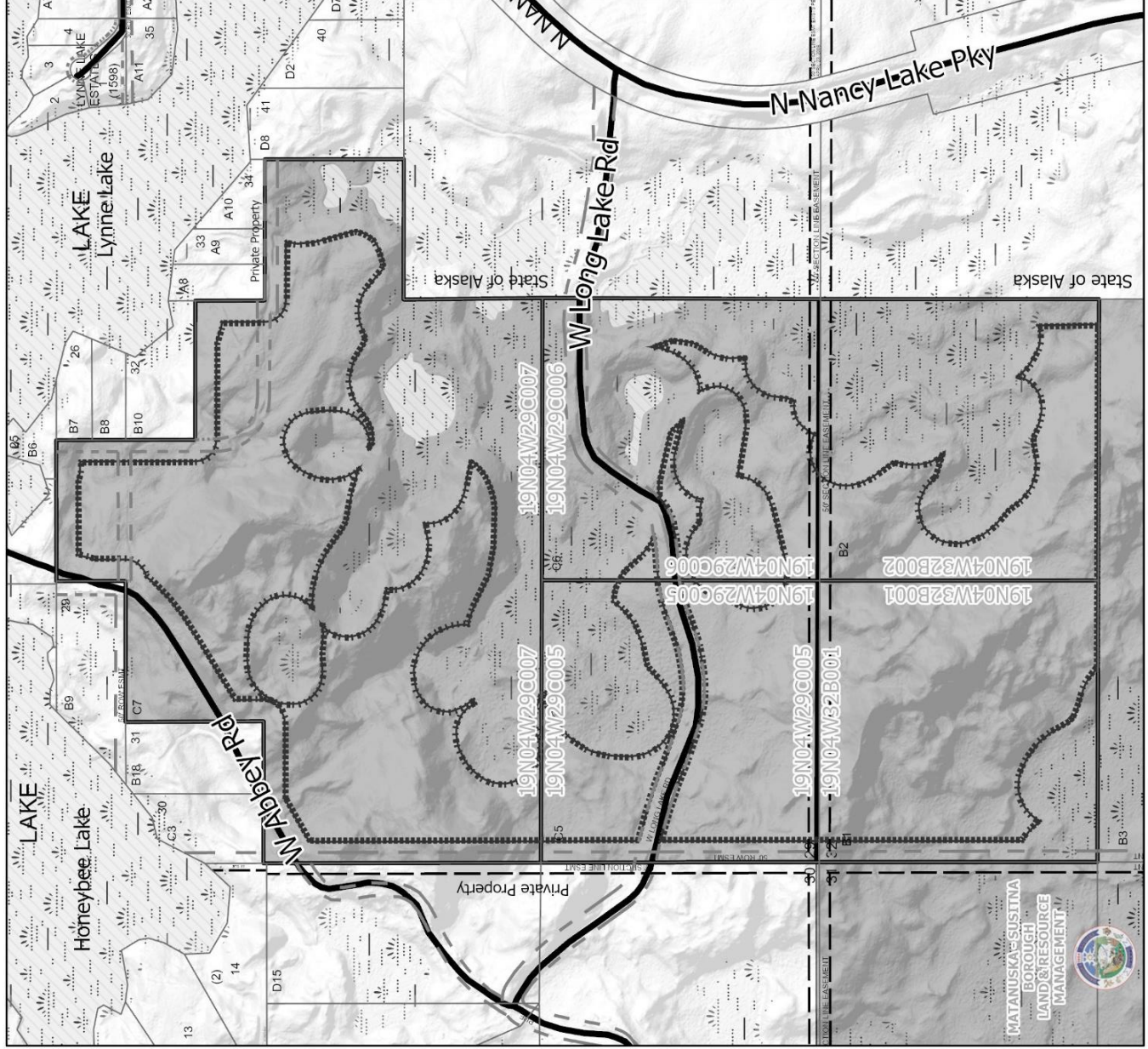
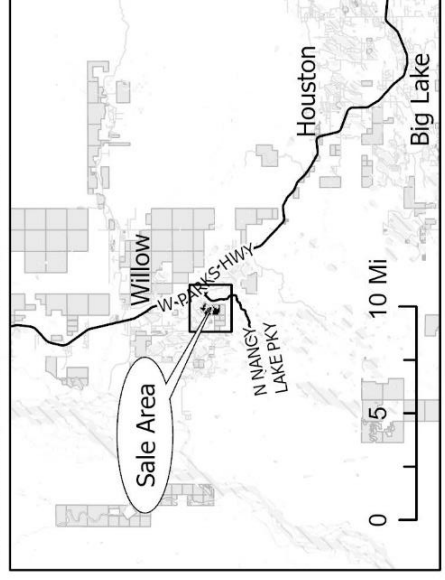

MATANUSKA-SUSTINA  
BOROUGH  
LAND & RESOURCE  
MANAGEMENT

